

THIS DRAWING IS AN UNCONTROLLED COPY UNLESS STAMPED OTHERWISE

CONTRACTORS SHALL VERIFY JOB DIMENSIONS BEFORE ANY JOB COMMENCES. ALL SHOP DRAWINGS SHALL BE SUBMITTED TO THE SUPERINTENDENT AND MANUFACTURER SHALL NOT COMMENCE PRIOR TO THE RETURN OF DIMENSIONED SHOP DRAWINGS SIGNED BY THE CONSULTANT. FOUR-DIGIT DIMENSIONS SHALL TAKE PRECEDENCE OVER SCALED. THIS DRAWING SHALL BE READ IN CONJUNCTION WITH ALL RELEVANT CONTRACT SPECIFICATIONS AND DRAWINGS COPYRIGHT OF THIS DRAWING IS VESTED IN NADAAA.

- General Notes
- CL-XX CEILING SYSTEM. REFER TO MATERIALS SCHEDULE
 - CH CEILING HEIGHT
 - FF-XX POWDERCOAT FINISH. REFER TO MATERIALS SCHEDULE
 - FA-XX PAINT FINISH. REFER TO MATERIALS SCHEDULE

- NOTES
1. REFER TO 2000 SERIES DWGS FOR CEILING FINISHES & SETOUT
 2. REFER TO SERVICES CONSULTANTS DOCUMENTATION FOR SPECIFICATION OF FIXTURES & FITTINGS BELOW
 3. ENSURE ALL EMERGENCY LIGHT SMOKE DETECTOR LIGHT FITTING WIRES ARE RETICULATED TO SLAB. ALL WIRING TO BE SPRAYED OR PRE-COLOURED TO MATCH ADJACENT CEILING. REFER TO MATERIALS SCHEDULE FOR DETAILS.
 4. ALL SERVICES TO BE POWDERCOATED OR PAINTED ON SITE TO MATCH CEILING COLOUR. REFER TO MATERIALS SCHEDULE FOR EXACT SPECIFICATION.
 5. TO BE READ IN CONJUNCTION WITH A0200 CEILING PLANS AND WITH A0100 FACADE DETAILS AND A0100 WALL TYPES DRAWINGS

Rev	Issue	Revision Description	And	Date
B	SG	PLASTERBOARD PACKAGE UPDATE	-	19.08.13
A	SG	UPDATED DETAILS AS CLOUDED	-	17.09.13
03	SG	UPDATES TO CEILING DETAILS	-	23.08.13
02	SG	100% CD - TENDER ISSUE	-	07.09.12
01	SG	90% CD ISSUE	-	10.08.12



NADAAA
 NADAAA
 1520 Washington Street No.2 Boston Massachusetts 02118 USA
 Telephone +1 617 442 8232 Facsimile +1 688 442 1417 Email nadaaa@nadaaa.com

John Wardle Architects
 25 Rokeby Street, Collingwood, Victoria 3066 Australia
 Tel : +61 3 8662 0400 www.johnwardlearchitects.com
 © 2012 John Wardle Architects ABN 83 006 814 268

Client **University of Melbourne Parkville Campus**
 Project **Faculty of Architecture Building and Planning**

Title **CEILING JUNCTION DETAILS**

	Project No. 0913	Scale 1:5 @ A0 1:10 @ A2
	Drawing No. AR 7853	Revision B

Date: Dec 2011 Drawn: Co-Ord: Chk:

FILENAME - SFILES
FOR CONSTRUCTION

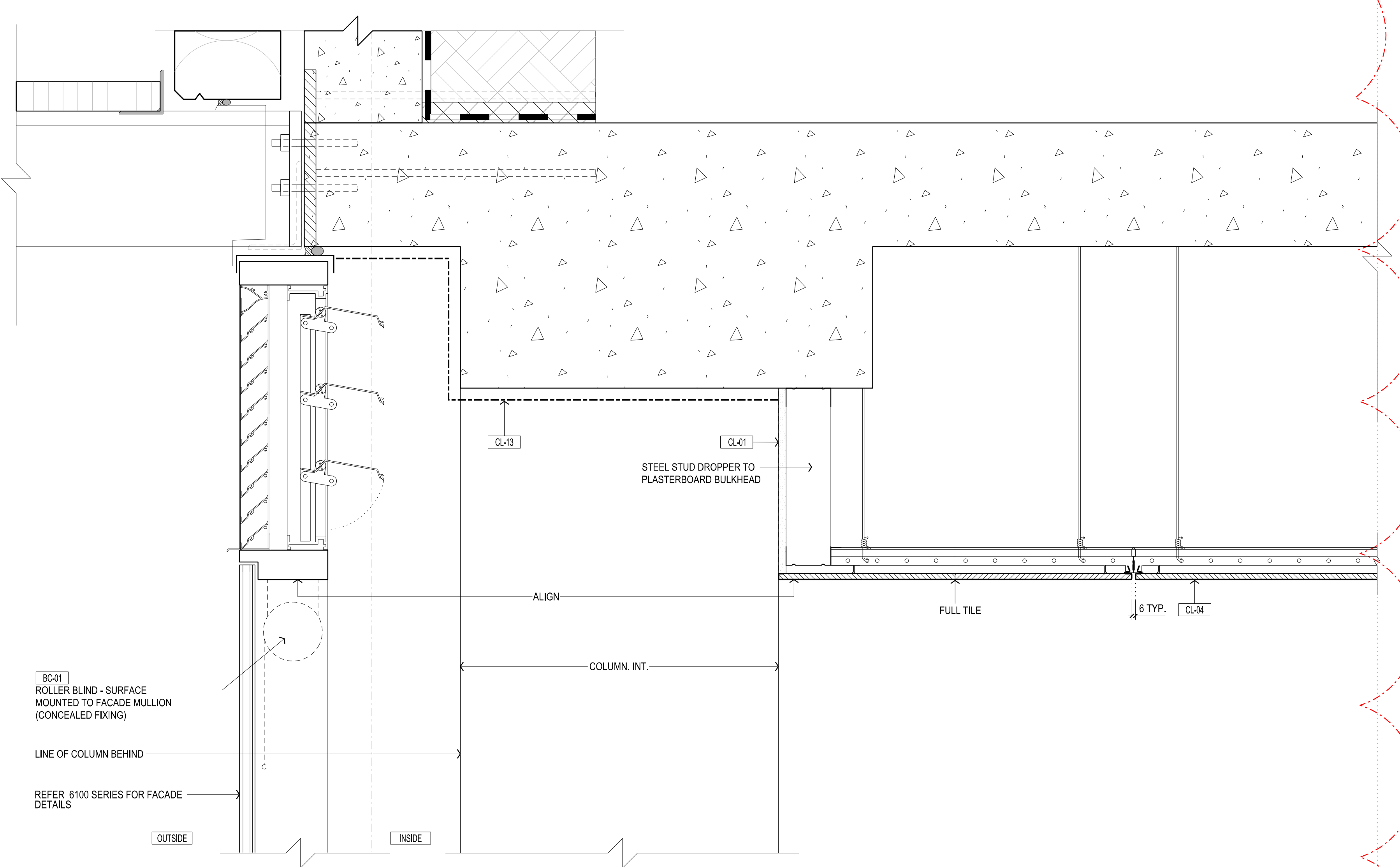

01 ALUMINIUM PELMET TO FACADE - OFFICES - TYPICAL SECTION DETAIL SCALE 1:5

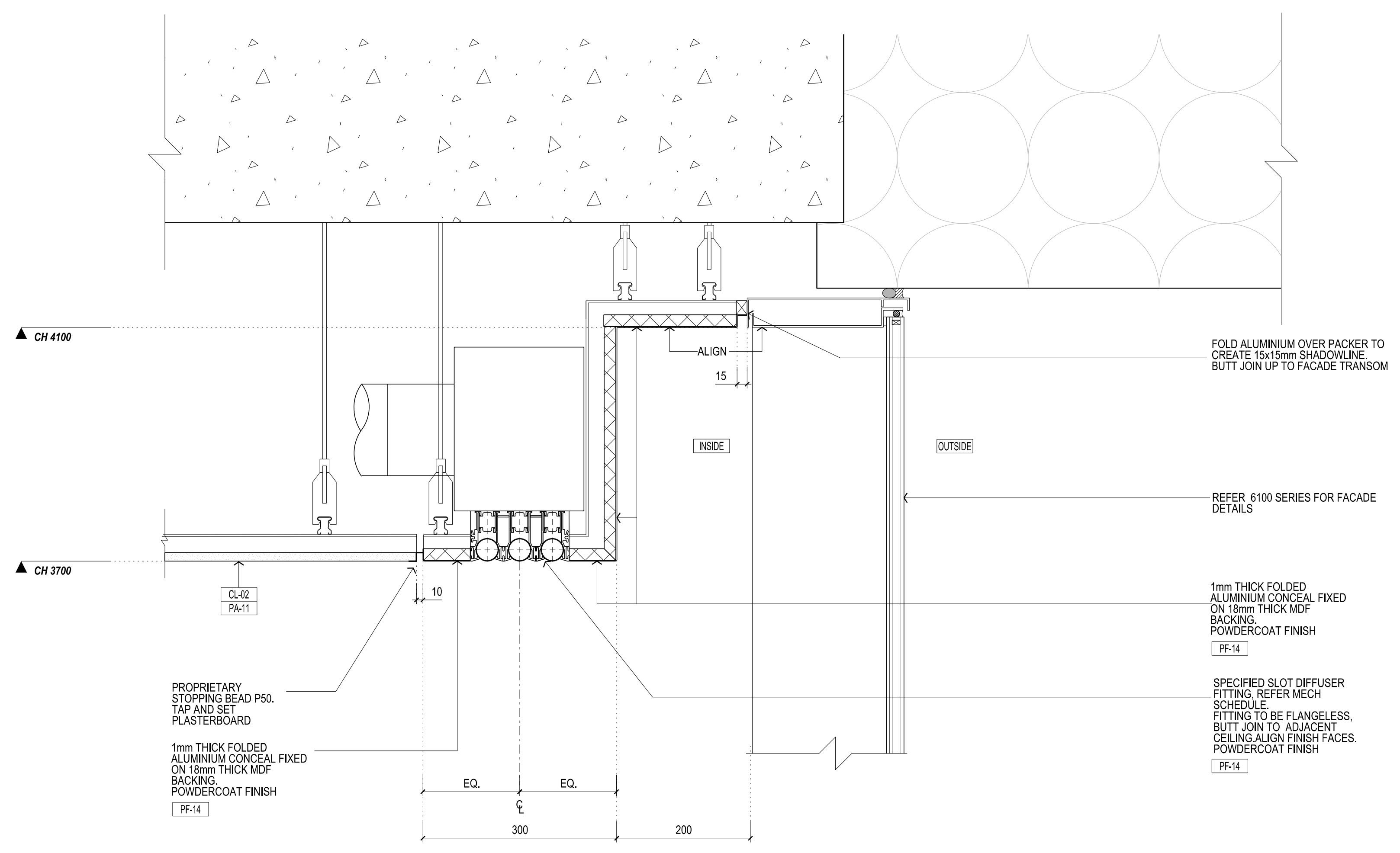

02 PELMET TO FACADE JUNCTION - G01 - LIBRARY COLLABORATIVE SPACE SECTION DETAIL SCALE 1:5

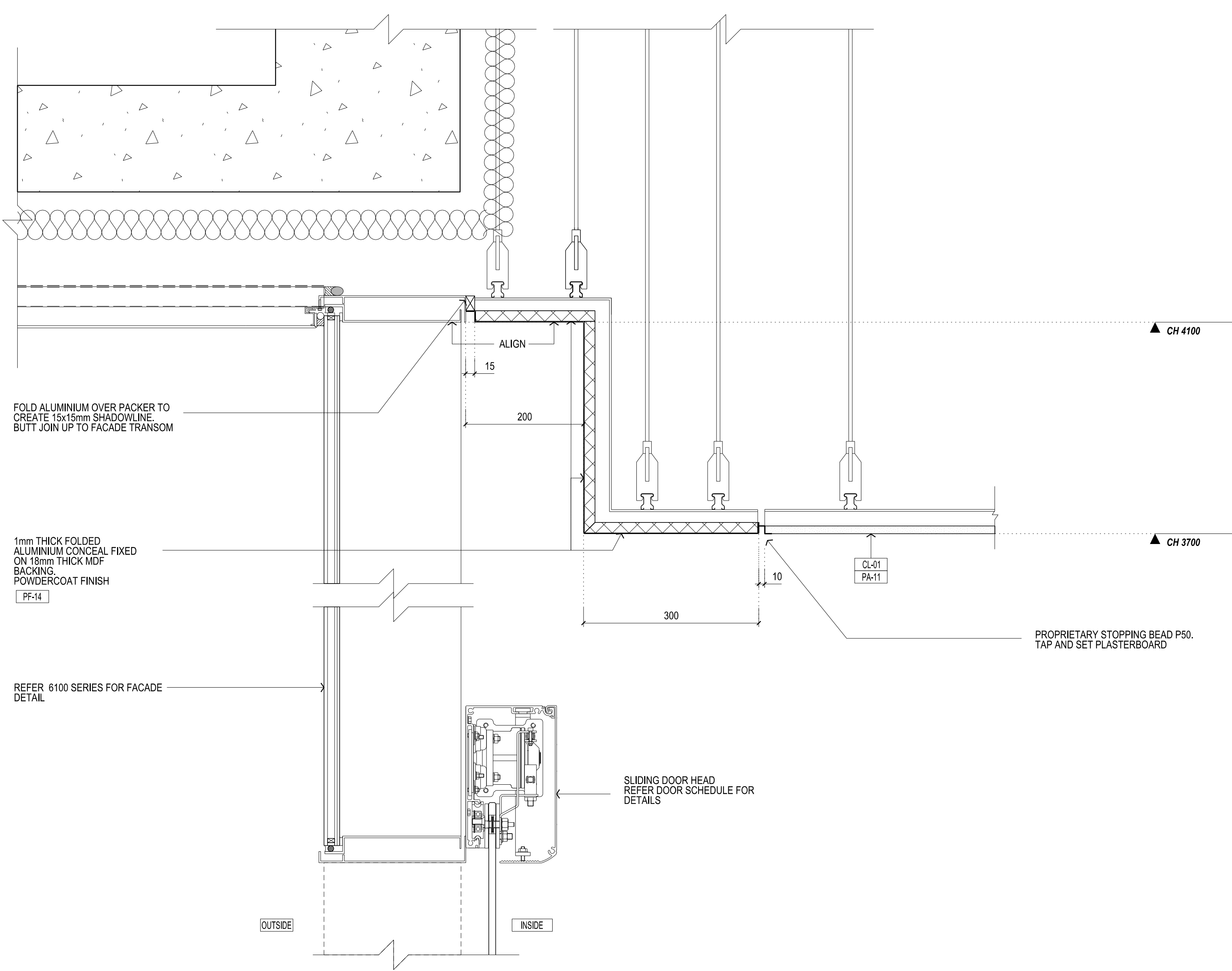

03 PELMET TO FACADE JUNCTION - G01 - AIRLOCK SECTION DETAIL SCALE 1:5

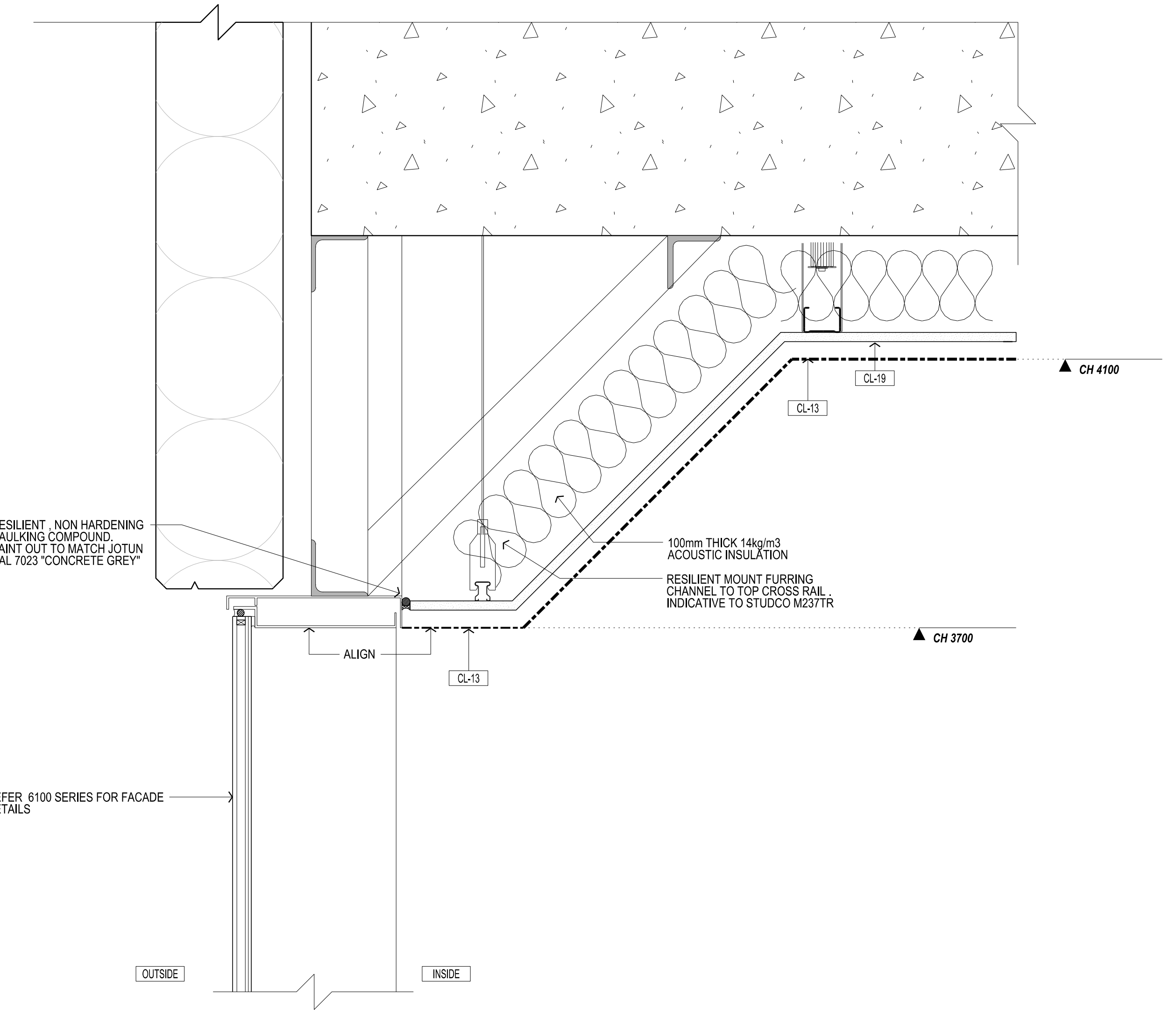

04 ACOUSTIC PLASTERBOARD TO FACADE G01 WORKSHOP SECTION DETAIL SCALE 1:5